

Package

Please make sure the following contents are in the HT1 series gift box. If something is missing or damaged, please contact your Unitech representative.

Package contents

- HT1 Handheld Computer
- Wrist Lanyard
- Battery
- Quick Start Guide
- QR Code Card

Optional accessories

- Extended Capacity Battery
- Single Slot Cradle + Cradle Adapter
- USB Cable
- USB Plugs Adapter
- 4-Slots Battery Charger

Handheld Computer

- HT1 Series- HT1 1D Batch / HT1 2D



Quick Start Guide

401363G V1.1

-1-

Product View (Front View)



Product View (Rear View)

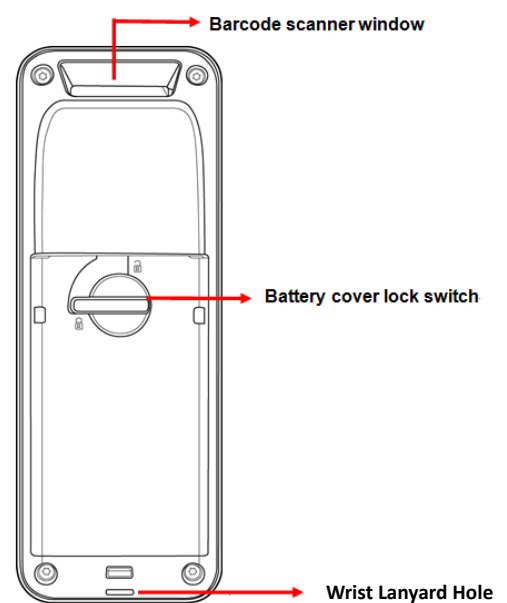

-2-

-3-

Installing the Battery

1. Turn the switch left to lock the battery cover.
Turn the switch up to unlock the battery cover.

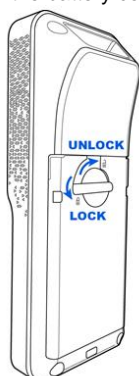

2. You can take the battery out directly.

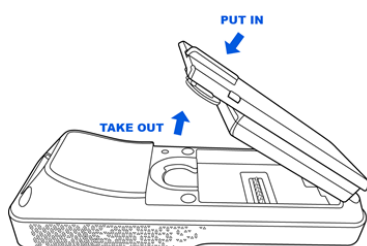

-4-

Charging the Battery

■ Charge with USB

Connect the micro USB cable to the USB port at the bottom of HT1 and plug into your PC's USB port to simultaneously charge the HT1. Or plug the AC power adapter into the electrical outlet on the USB plug.

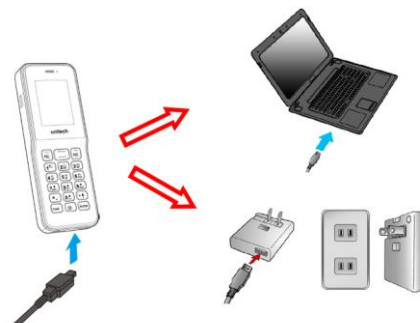



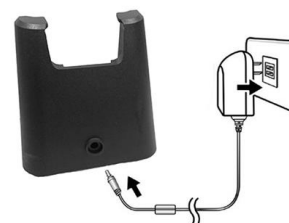





■ Charge with cradle



-5-

Keypad Definition













Key	Description
	Power key
	Enter key
	Alpha key
	Function key
	Trigger Key
	Escape Key
	Alphanumeric keys
	Back Key

-6-

Using Function keys

Press the function key once, it will appear a blue symbol  in the status bar at the top of the screen. Then you can refer to the following table to execute the desired function or input.

Key	Description (Func)
	Return
	Home
	Menu
  	Programmable key F1~F3
   	Left, Up, Right, Down cursor keys

- CAUTION!** • To ensure the unit working properly, please keep all connectors away from the contaminants staying inside of them such as dust, grease, mud, and water. The negligence may cause the unit with no communication, short circuited, overheated and so on.
- If the connector is damaged, please ensure the connector is being fully repaired before using the unit to avoid causing short circuited.

<http://www.ute.com/>

-7-